

VISION

Designed by Adrian Smith + Gordon Gill Architecture, Una takes inspiration from the elegant shapes and materials of classic yacht design. Instantly recognizable by the sweeping curve of the building's dramatic silhouette, the residences' glass surfaces brilliantly reflect the dazzling sunlight, and floor-to-ceiling windows take advantage of a coveted setting on Biscayne Bay. Una's striking architecture is complemented by lush gardens designed by Enzo Enea, an extensive amenities program, and private boat slips. With easy access to Coconut Grove, Downtown, Brickell, Miami International Airport, and the beaches of Key Biscayne, Una is an exemplar for Miami living.



The dramatic entryway at Una is marked by a curvilinear double-height porte cochère.

DESIGN

From a distance, the iconic tower is recognizable by the smooth, light-metallic surface and striking silhouette that recalls the natural shape of a wave. Once inside, residents are met with stunning views of Biscayne Bay at every turn. Floor-to-ceiling windows welcome daylight into each open-plan space, while extra wide terraces are carefully integrated into the great rooms and bedrooms. The result is a seamless transition between inside and outside, celebrating the pleasures of life on the bay.



Floor-to-ceiling windows in main living areas enhance the breathtaking bayfront views.



The level of craftsmanship in the lobby is instantly breathtaking, with wood and precious detailing permeating the 20-foot-high space and a long bank of windows framing the sparkling views of the bay.



Sleek and spa-like, the master bathrooms feature a material mix of natural stone selections, stained wood and porcelain tile, creating an atmosphere of peace and relaxation.



The sublime views of Biscayne Bay and beyond can be enjoyed to the fullest on the 10-foot-deep terraces.

RESIDENCE TYPES

2 RESIDENCES
LEVELS 38 – 43
4 Bedrooms, 6.5 Baths, Den
4,697 SQ FT / 4,786 SQ FT

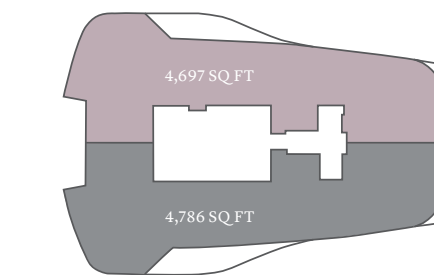

Biscayne Bay

4 RESIDENCES
LEVELS 19 – 37
FLOORS 19 – 29
3 Bedrooms, 3.5 Baths
1,915 SQ FT / 1,995 SQ FT
4 Bedrooms, 4.5 Baths
2,724 SQ FT / 2,731 SQ FT

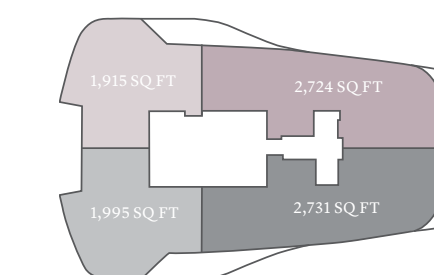

Biscayne Bay

FLOORS 30 – 37
3 Bedrooms, 3.5 Baths
1,939 SQ FT / 2,019 SQ FT
4 Bedrooms, 5 Baths
2,759 SQ FT / 2,766 SQ FT

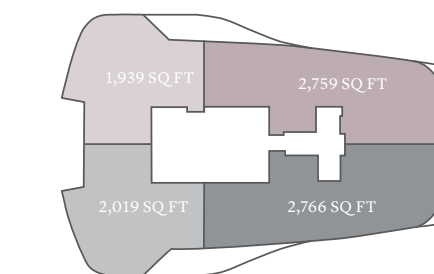

Biscayne Bay

1 RESIDENCE
LEVELS 17 – 18
4 Bedrooms, 4.5 Baths
4,222 SQ FT

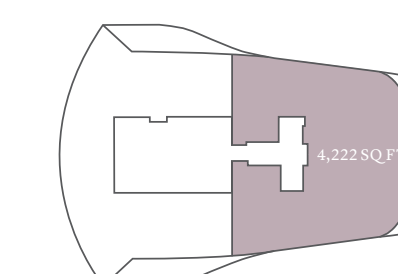

4 RESIDENCES
LEVELS 5 – 16
2 Bedrooms, 2 Baths
1,098 SQ FT / 1,179 SQ FT
3 Bedrooms, 3.5 Baths
2,108 SQ FT / 2,115 SQ FT

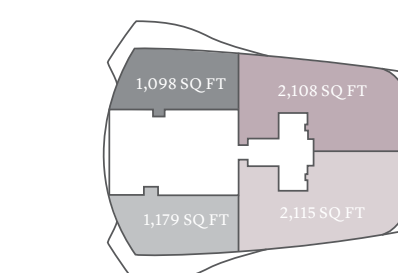

Biscayne Bay



NEIGHBORHOOD
 Una's setting in the scenic Brickell Waterfront area takes advantage of the natural beauty of South Florida as well as all the conveniences of Miami. Direct waterfront access, walking paths, public parks, and bike routes make it easy to engage with the brilliant landscapes all around. A peaceful, idyllic residential neighborhood with a wealth of dining, cultural, and retail destinations, plus plenty of options for running, cycling, and boating, all just steps from Una's front door.



TEAM
 Development: OKO Group and Cain International
 Design Architect: AS+GG
 Interior Design: AS+GG
 Landscape Architect: Enea Landscape Architecture
 Executive Architect: Revuelta Architecture International

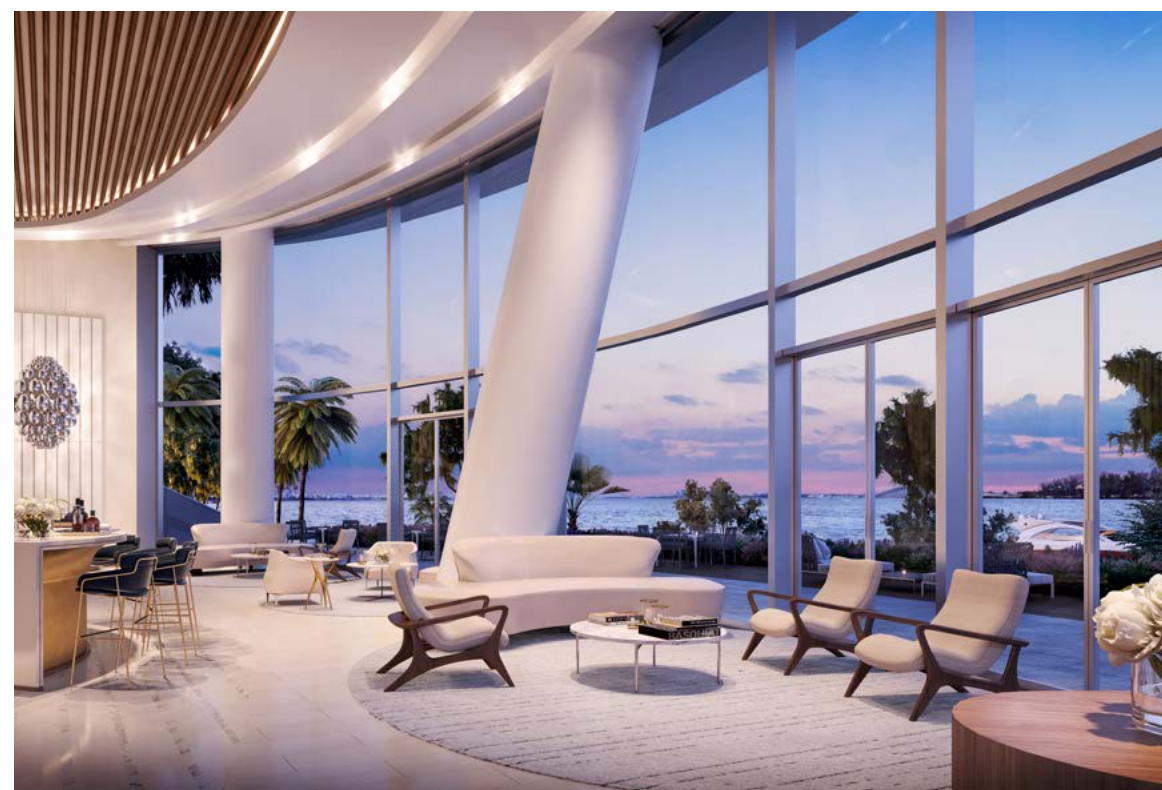

The private owners' lounge, adjacent to the lobby, features a double height bank of windows with sweeping views of the water and the private gardens.



A unique oasis, the third-floor pool deck offers a lap pool, family pool and a children's play area, along with cabanas and outdoor bars.

AMENITIES
 Una's amenities represent the best of leisure, wellness, and entertaining—offering a range of curated indoor and outdoor spaces, all set around spectacular Biscayne Bay. Whether enjoying a relaxing afternoon on the bayfront pool deck, or entertaining in the private dining room and party space, residents have a range of amenity options to enjoy. The spa and gym, elegantly envisioned by the chairman of Aman, promote health and wellness while maximizing water views. Una is family friendly, with a colorful children's play area, perfect for the younger generation of residents.

AMENITIES LIST

- Access to the exclusive Grand Bay Club in Key Biscayne
- Bayfront pool
- Outdoor lap pool
- Family pool
- Jacuzzi
- Catering kitchen
- Kids' splash-pad area
- Owners' lounge
- Private dining/party room
- Movie theater
- Kids' playroom
- Outdoor lounge
- Baywalk access
- State-of-the-art fitness center with yoga and personal training areas, plus his and hers dressing rooms

- Private marina
- Spa with steam room and sauna, as well as indoor and outdoor private massage treatment rooms overlooking the bay
- Dedicated beauty suite for private hairstyling, manicure and pedicure appointments
- Beautifully landscaped outdoor terraces
- Dog-walk area
- Private air-conditioned storage areas

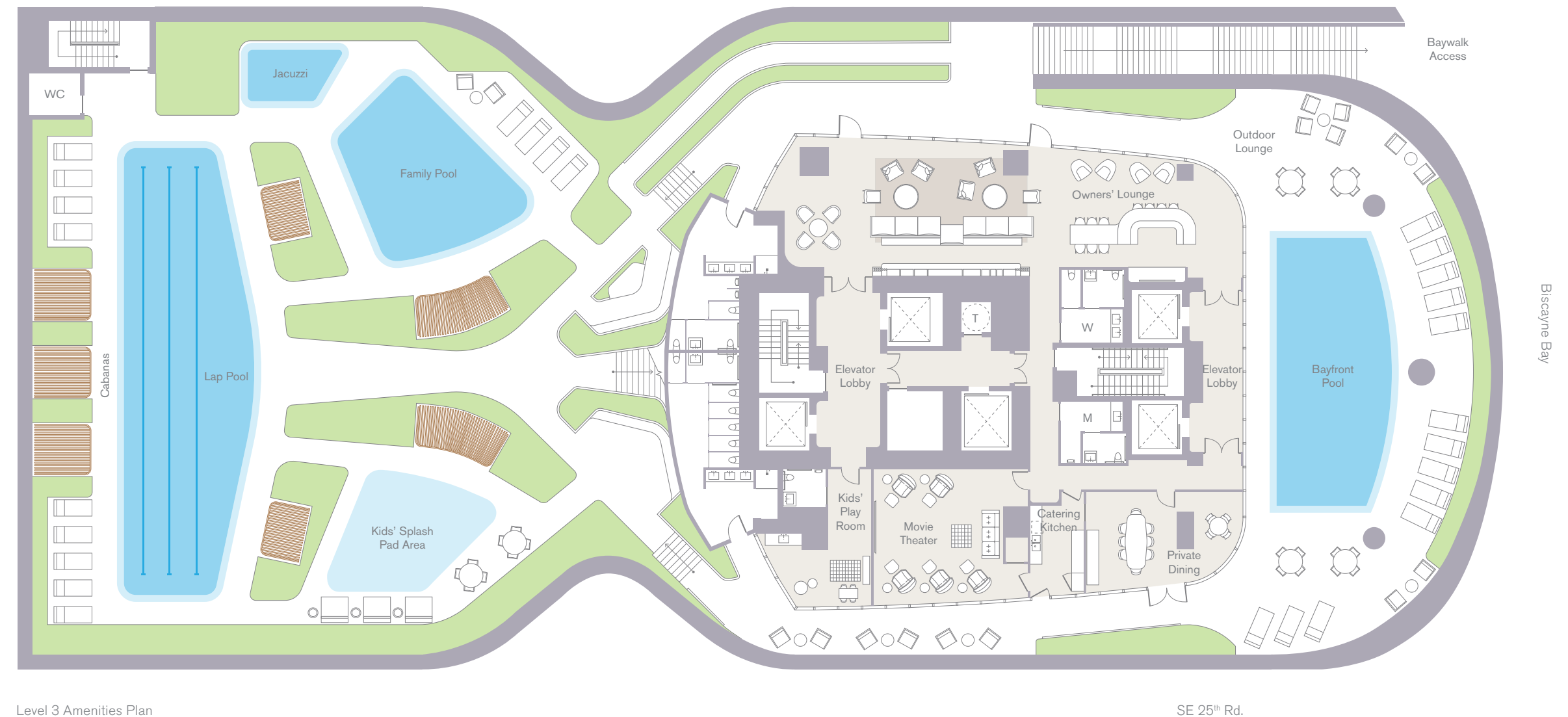

Level 3 Amenities Plan

SE 25th Rd.

Una
 Residences

OKO GROUP **Cain International**

All images and designs depicted herein are artists' conceptual renderings, which are based upon preliminary development plans and are subject to change without notice in the manner provided in the offering documents. All such materials are not to scale and are shown solely for illustrative purposes. Renderings depict proposed views, which are not identical from each unit. No guarantees or representations whatsoever are made that existing or future views of the project and surrounding area depicted by artists' conceptual renderings or otherwise described herein, will be provided or, if provided, will be as depicted or described herein. Any view from a unit of from other portions of the property may in the future be limited or eliminated by future development or forces of nature, and the developer in no manner guarantees the continuing existence of any view. The photographs contained in this brochure may be stock photography or have been taken off-site and are used to depict the spirit of the lifestyle to be achieved rather than any that may exist or that may be proposed, and are merely intended as illustration of the activities and concepts depicted therein. Interior photos shown may depict options and upgrades and are not representative of standard features and may not be available for all model types. All fixtures, furniture, and items of finish and decoration of units described herein are for display only and may not be included with the unit, unless expressly provided in the purchase agreement. We are pledged to the letter and spirit of US policy for the achievement of equal housing throughout the nation. We encourage and support an affirmative advertising, marketing and sales program, in which there are no barriers to obtaining housing because of race, color, sex, religion, handicap, familial status or national origin. This condominium is being developed by Miami Waterfront Ventures, LLC, a Delaware limited liability company ("Developer"), which has a limited right to use the trademarks names and logos of OKO Group. Any and all statements, disclosures and/or representations shall be deemed made by Developer and not by OKO Group and you agree to look solely to Developer (and not to OKO Group and/or any of its affiliates) with respect to any and all matters relating to the marketing and/or development of the Condominium and with respect to the sales of units in the Condominium. The private marina is proposed only and subject to the Developer obtaining all required permits, licenses and approvals to construct and operate same. There is no assurance as to whether same will be obtained or if obtained, as to the number of slips to be included in the marina.